

## ALUMINUM LONG STARTING COLLAR—AX12 (no damper)

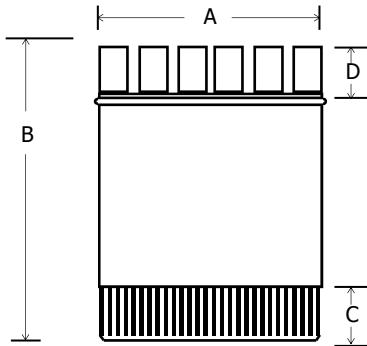

A	B	C	D
4	6	1.75	1.0
5	6	1.75	1.0
6	6	1.75	1.0
7	6	1.75	1.0
8	6	1.75	1.0
9	6	1.75	1.0
10	6	1.75	1.0
12	6	1.75	1.0

Aluminum long start collar with tabs and 1/4" bead. Crimp one end.  
Aluminum rivets, minimum 4 rivets.

### **PART NUMBER DESIGNATIONS**

#### **AX12xx (no damper)**

XX = Diameter (04-12)

PROJECT: _____	COMPANY: _____	DATE : _____
LOCATION: _____	SUBMITTED BY: _____	